

FINISH - HOT DIP GALVANIZED

|             |           |   |  |            |                               |
|-------------|-----------|---|--|------------|-------------------------------|
| DESCRIPTION | DRAWN BY  | NOTE:-<br>All Dimensions are in "mm"<br>Unless otherwise specified. |  | CLIENT     | MANUFACTURER                  |
| MARK NO.    | CHKD. BY  | Scale: 1:1  |  | TITLE      | BARRIER 3200, Thickness 2.5mm |
| SECTION     | APPD. BY  |   |  | PART CODE. |                               |
| LENGTH      | HOLE DIA  |   |  |            |                               |
| QTY/TWR     | TOTAL QTY | GENERAL TOLERANCE: ±5%  |  |            |                               |

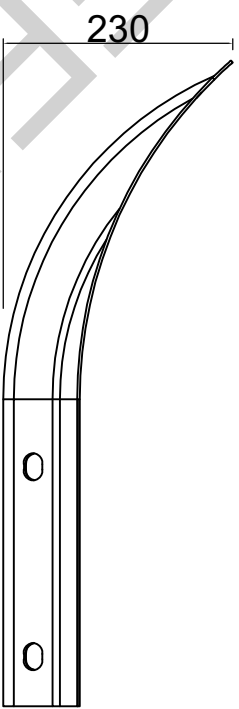

PLAN VIEW

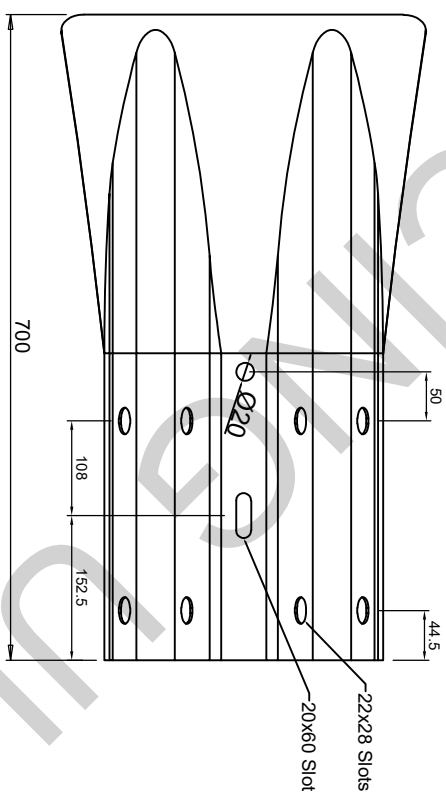

FACE VIEW

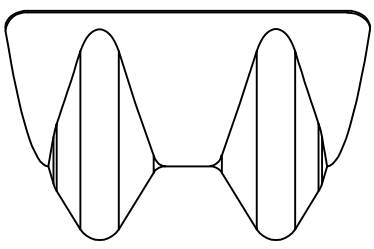

LEFT VIEW

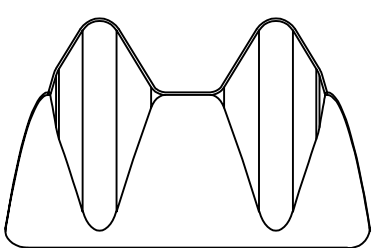

RIGHT VIEW

FINISH - HOT DIP GALVANIZED

|             |          |  |                           |
|-------------|----------|--|---------------------------|
| DESCRIPTION | DRAWN BY | <b>NOTE:-</b><br>All Dimensions are in "mm"<br>Unless otherwise specified.<br><br>Scale: 1:1<br><br>GENERAL TOLERANCE: ±5% | CLIENT                    |
| MARK NO.    | CHKD. BY |  | MANUFACTURER              |
| SECTION     | APPD. BY |  | TITLE                     |
| LENGTH      |          |  | PART NO.                  |
| QTY/TWR     |          |  |                           |
|             |          |  | Fishtail, thickness 2.5mm |

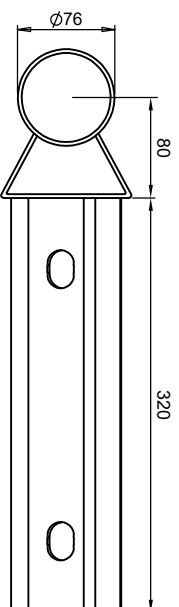

PLAN VIEW

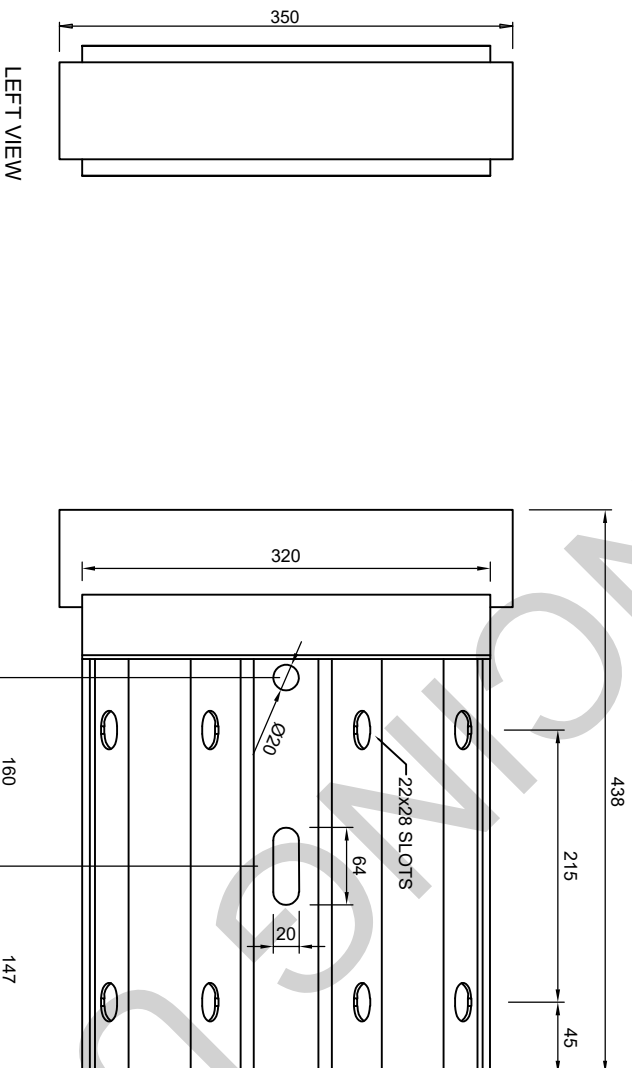

FACE VIEW

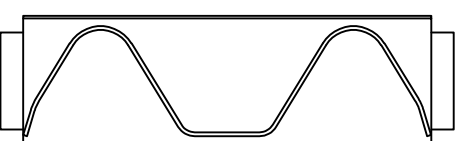

RIGHT VIEW

LEFT VIEW

FINISH - HOT DIP GALVANIZED

| DESCRIPTION | DRAWN BY   |  | NOTE:-  |  | CLIENT                  |  |
|-------------|------------|--|---|--|-------------------------|--|
| MARK NO.    | CHKD. BY   |  | All Dimensions are in "mm"<br>Unless otherwise specified. |  | MANUFACTURER            |  |
| SECTION     | APPD. BY   |  |   |  | TITLE                   |  |
| LENGTH      | SOLE DIA   |  |   |  | PEDESTRIAN END TERMINAL |  |
| QTY/TWR     | TOTAL QTY- |  | Scale: 1:1  |  | PART NO.                |  |
|             |            |  | GENERAL TOLERANCE: ±5%                                    |  |                         |  |

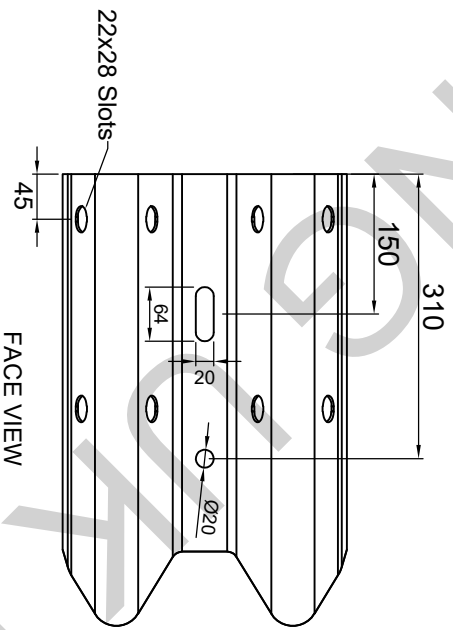
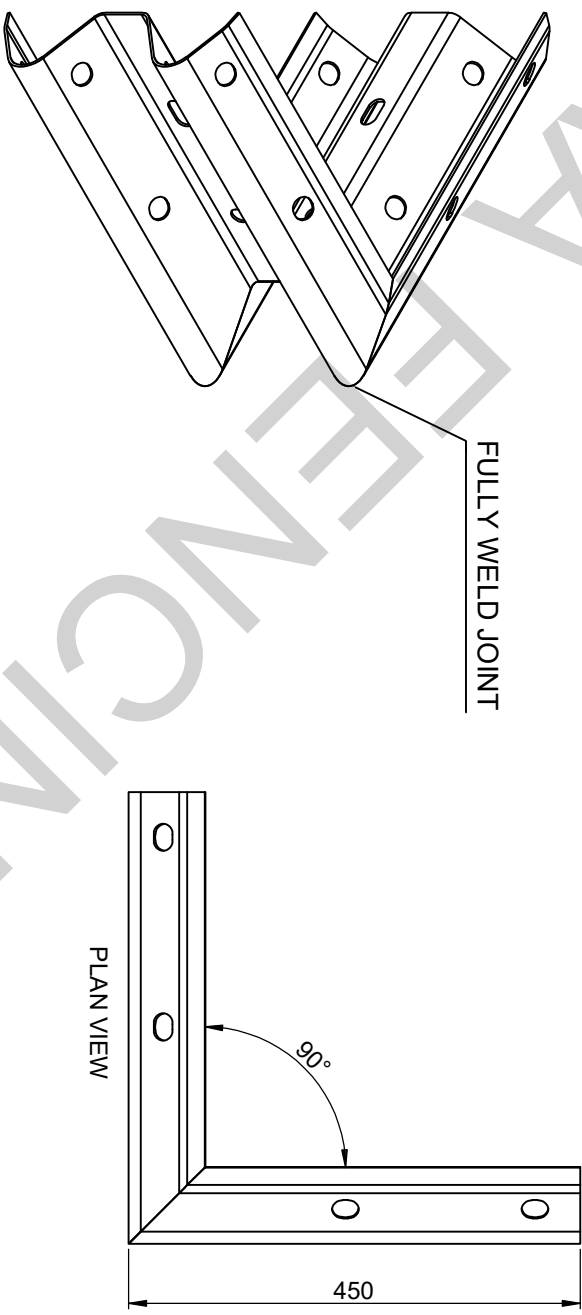

FINISH - HOT DIP GALVANIZED

|             |          |   |  |              |                     |
|-------------|----------|---|--|--------------|---------------------|
| DESCRIPTION | DRAWN BY | NOTE:-  |  | CLIENT       |                     |
|             |          | All Dimensions are in "mm"<br>Unless otherwise specified. |  | MANUFACTURER |                     |
| MARK NO.    | CHKD. BY |   |  |              |                     |
| SECTION     | APPD. BY |   |  | TITLE        | 90° EXTERNAL CORNER |
| LENGTH      |          | Scale: 1:1  |  | PART CODE.   |                     |
| QTY/TWR     |          | General Tolerance: ±5%                                    |  |              |                     |

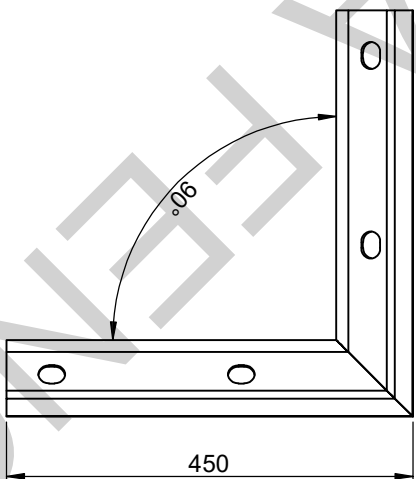

PLAN VIEW

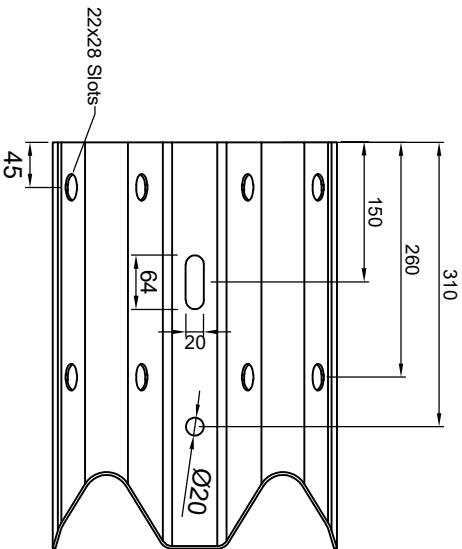

FACE VIEW

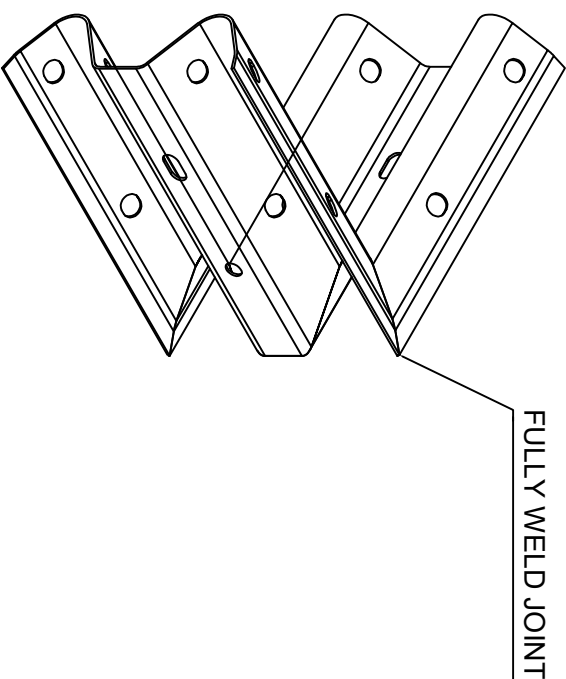

FULLY WELD JOINT

FINISH - HOT DIP GALVANIZED

| DESCRIPTION |  | DRAWN BY    |  | NOTE:-  |  | CLIENT       |                     |
|-------------|--|-------------|--|---|--|--------------|---------------------|
| MARK NO.    |  | CHKD. BY    |  | All Dimensions are in "mm"<br>Unless otherwise specified. |  | MANUFACTURER |                     |
| SECTION     |  | APPD. BY    |  |   |  | TITLE        | 90° INTERNAL CORNER |
| LENGTH      |  | HOLE DIA    |  |   |  | PART NO.     |                     |
| QTY/TWR     |  | TOTAL QTY - |  | General Tolerance: ±5%                                    |  |              |                     |

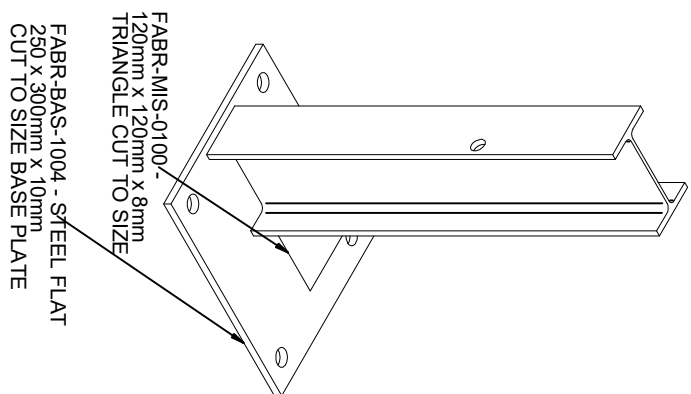
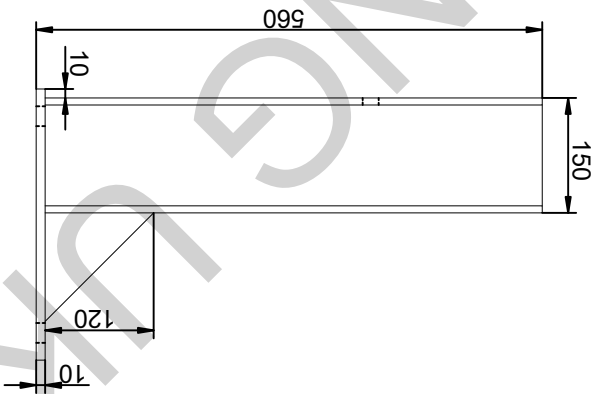
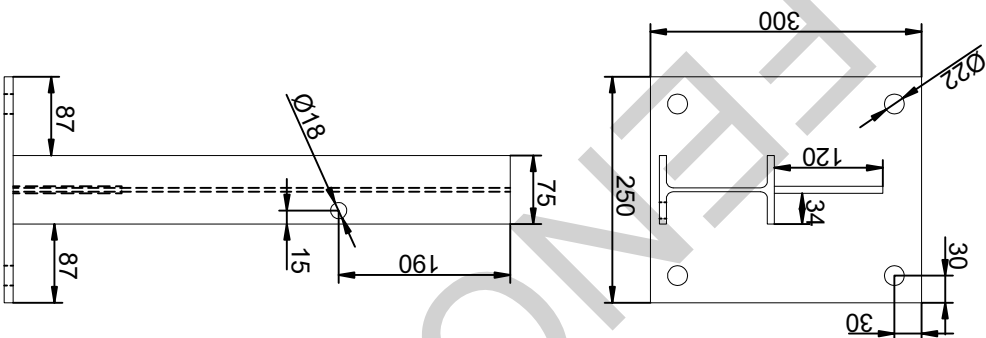

FINISH - HOT DIP GALVANIZED

|             |  |             |  |  |              |                           |
|-------------|--|-------------|--|--|--------------|---------------------------|
| DESCRIPTION |  | DRAWN BY    |  | <b>NOTE:-</b><br>All Dimensions are in "mm"<br>Unless otherwise specified.<br><br>Scale: 1:1<br><br>General Tolerance: ±5% | CLIENT       |                           |
| MARK NO.    |  | CHKD. BY    |  |  | MANUFACTURER |                           |
| SECTION     |  | APPD. BY    |  |  | TITLE        | 560mm bolt down RSJ Posts |
| LENGTH      |  | HOLE DIA    |  |  | PART NO.     |                           |
| QTY/TWR     |  | TOTAL QTY - |  |  |              |                           |

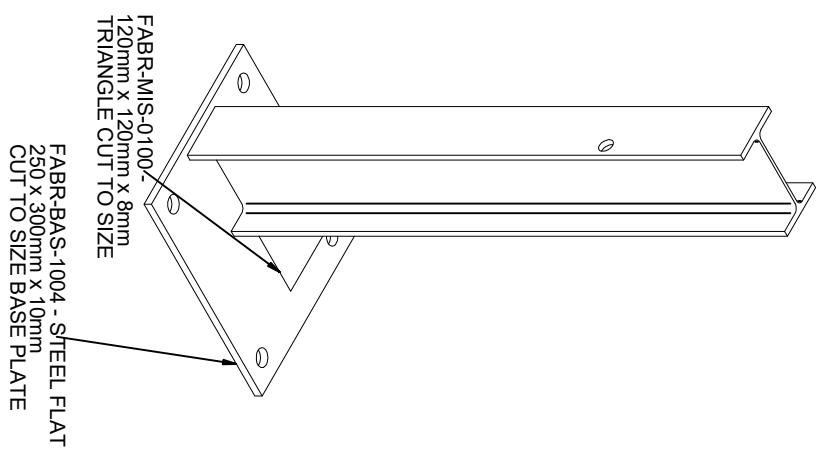
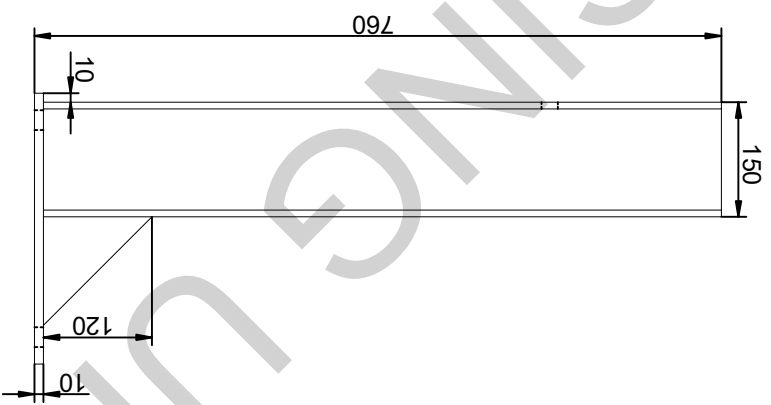
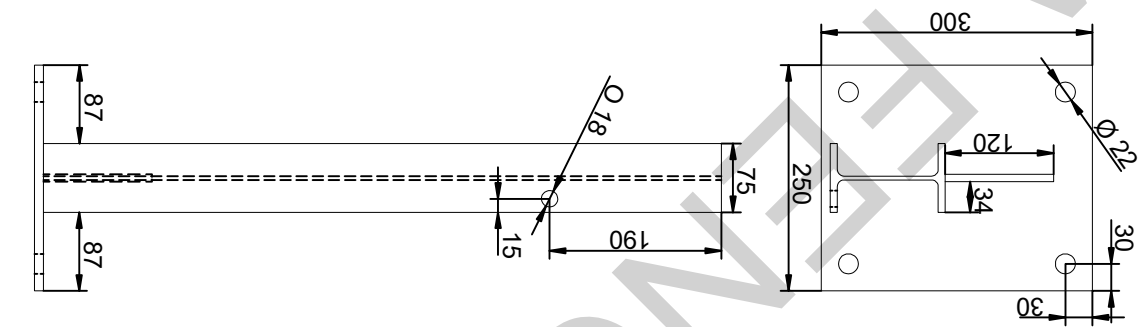

FINISH - HOT DIP GALVANIZED

| DESCRIPTION |  | DRAWN BY    |  | NOTE:-<br>All Dimensions are in "mm"<br>Unless otherwise specified.<br><br>Scale: 1:1<br><br>General Tolerance: ±5% |  | CLIENT       |  |
|-------------|--|-------------|--|---|--|--------------|--|
| MARK NO.    |  | CHKD. BY    |  |   |  | MANUFACTURER |  |
| SECTION     |  | APPD. BY    |  |   |  | TITLE        |  |
| LENGTH      |  | HOLE DIA    |  |   |  | PART NO.     |  |
| QTY/TWR     |  | TOTAL QTY - |  |   |  |              |  |

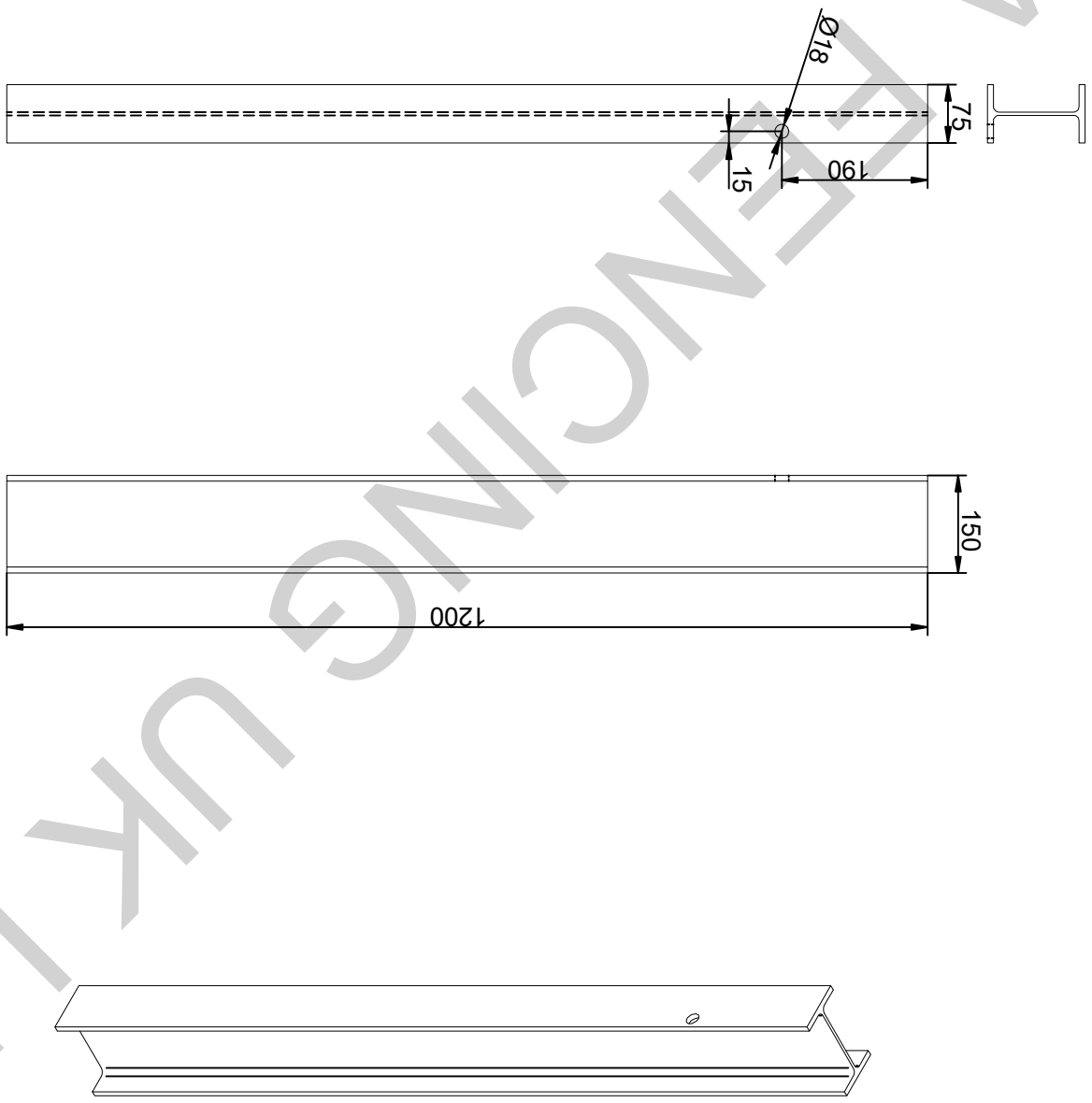

FINISH - HOT DIP GALVANIZED

| DESCRIPTION |  | DRAWN BY    |  | <div>NOTE:-<br/>All Dimensions are in "mm"<br/>Unless otherwise specified.<br/><br/>Scale: 1:1<br/><br/>General Tolerance: ±5%</div> |  | CLIENT       |                    |
|-------------|--|-------------|--|--|--|--------------|--------------------|
| MARK NO.    |  | CHKD. BY    |  |  |  | MANUFACTURER |                    |
| SECTION     |  | APPD. BY    |  |  |  | TITLE        | Dwg in post 1200mm |
| LENGTH      |  | HOLE DIA    |  |  |  | PART NO.     |                    |
| QTY/TWR     |  | TOTAL QTY - |  |  |  |              |                    |



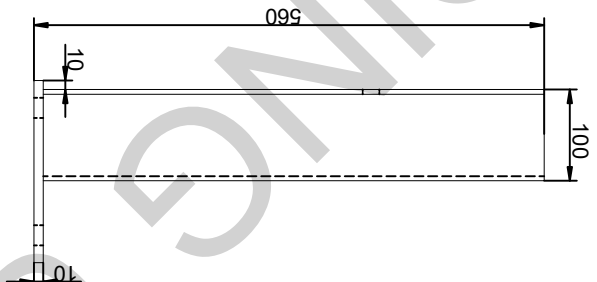
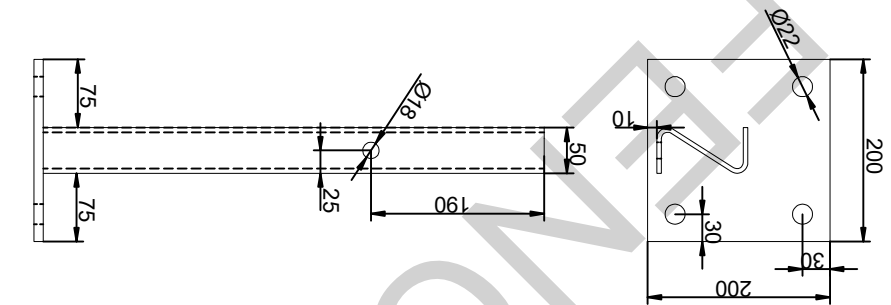

MILD STEEL SHEARED  
BLANKS 550 x 207mm CUT TO SIZE

STEEL FLAT  
200 x 200mm x 10mm CUT TO SIZE BASE PLATE

FINISH - HOT DIP GALVANIZED

|             |             |   |              |
|-------------|-------------|---|--------------|
| DESCRIPTION | DRAWN BY    | NOTE:-<br>All Dimensions are in "mm"<br>Unless otherwise specified. | CLIENT       |
| MARK NO.    | CHKD. BY    |   | MANUFACTURER |
| SECTION     | APPD. BY    |   | TITLE        |
| LENGTH      | HOLE DIA    |   | PART NO.     |
| QTY/TWR     | TOTAL QTY - | General Tolerance: ±5%  |              |

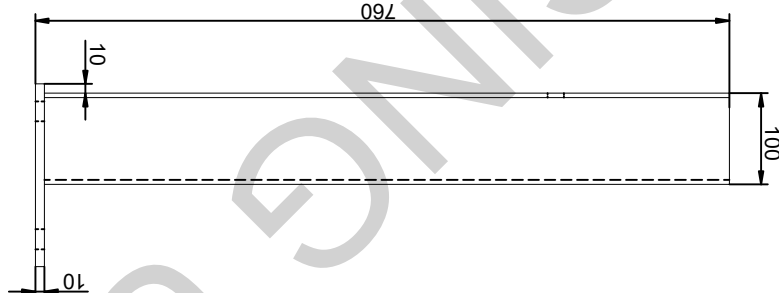
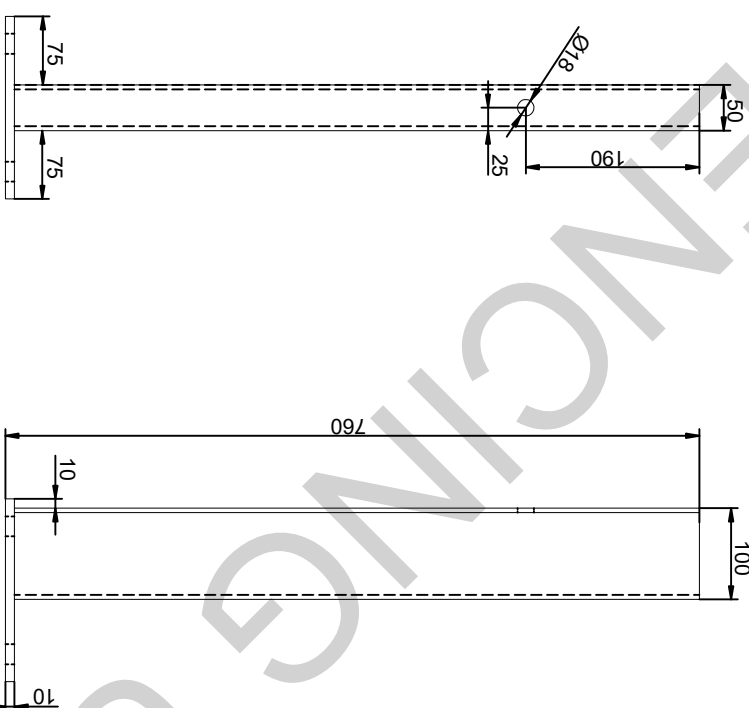
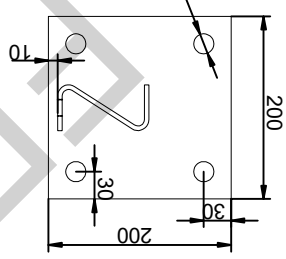

MILD STEEL SHEARED  
BLANKS 750 x 207mm CUT TO SIZE

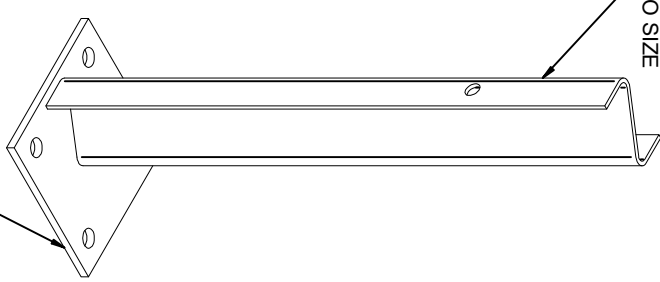

STEEL FLAT  
200 x 200mm x 10mm CUT TO SIZE BASE PLATE

Bolt down Z post 760mmNEXO INDUSTRIES PVT. LTD

FINISH - HOT DIP GALVANIZED

| DESCRIPTION | DRAWN BY    | NOTE:-  | CLIENT       |
|-------------|-------------|---|--------------|
| MARK NO.    | CHKD. BY    | All Dimensions are in "mm"<br>Unless otherwise specified. | MANUFACTURER |
| SECTION     | APPD. BY    |   | TITLE        |
| LENGTH      | HOLE DIA    |   | Part No.     |
| QTY/TWR     | TOTAL QTY - | General Tolerance: ±5%                                    |              |